

# FLOORPLAN



## THE INCHGOWER, DALMORE, GLENGOYNE AND GLENORDIE ROOMS - (NO FLOOR PLAN SHOWN)

The Inchgower, Dalmore, Glengoyne and Glenordie Rooms are located on the sixth floor and have panoramic views over the river and Kilpatrick hills. These rooms are ideal for business meetings, training courses and sales seminars and as with all the rooms they can be fully serviced with technical support and catering for morning coffee, lunch and dinner.

Our meeting and syndicate rooms on the fifth floor offer similar panoramic views and being inter-connecting are ideal for recruitment or staff appraisal but as with the sixth floor they offer the flexibility to suit most requirements.

## MEETING ROOMS / SYNDICATE ROOMS 5th FLOOR

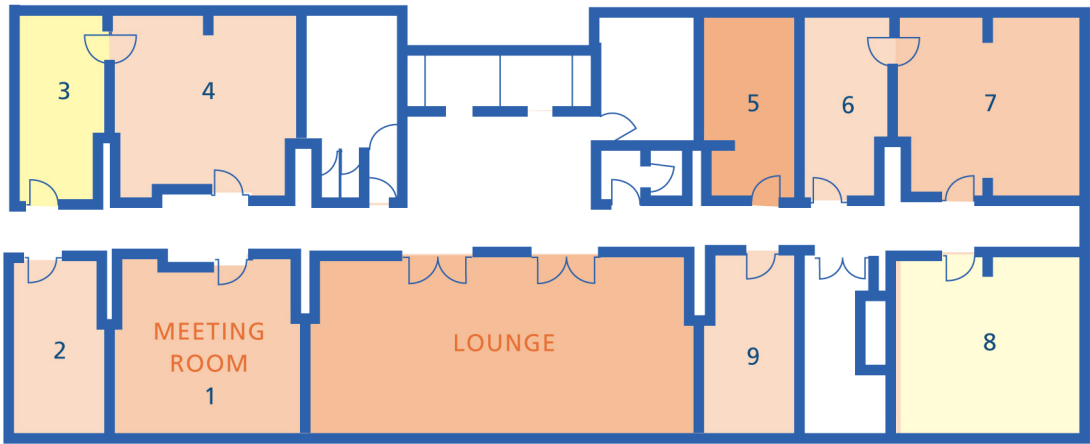

### DIMENSIONS

Room 1	(6.9m x 6.3m)
Room 2	(3.3m x 6.3m)
Room 3	(3.3m x 6.3m)
Room 4	(6.9m x 6.3m)
Room 5	(3.3m x 6.3m)
Room 6	(3.3m x 6.3m)
Room 7	(6.9m x 6.3m)
Room 8	(6.9m x 6.3m)
Room 9	(3.3m x 6.3m)
Lounge	(14.0m x 6.3m)